



AVK SWING CHECK VALVE, PN 10/16

41/60

Resilient seated, with free shaft end

003

AVK series 41 swing check valves come with both metal and resilient seats. Installed in pumping applications to prevent back flow they can be used for drinking water as well as waste water. The disc is connected to the shaft via a flexible bush that allows disc and valve seat to adjust exactly. All interior parts are stainless steel or coated with drinking water approved epoxy or EPDM. The series 41 valves are available with either closed bushings or protruding shaft end where a lever with a weight or a spring can be fitted to mitigate pressure surges.

Product Description:

Swing check valve - resilient seated with free shaft end for drinking water and neutral liquids to max. 70°C

Standards:

- Designed according to EN 1074 - 3
- Face to face according to EN 558 Table 2 Basic Series 48
- Standard flange drilling to EN1092-2 (ISO 7005-2), PN 10/16

Test/Approvals:

- Hydraulic test according to EN12050-4.
- Approved according to LGA regulations

Features:

- Full bore and low head loss.
- Shaft of stainless steel fitted in the bonnet allowing easy access to maintenance.
- Hinge of acid-resistant stainless steel in DN 50-200 and ductile iron in DN 250-300, tightened around the shaft with bolts to eliminate play and thus ensure durability.
- Bonnet gasket of EPDM rubber in a groove between bonnet and body.
- Disc with steel insert fully vulcanized with EPDM rubber. Due to its light weight a minimum of force is required to open and close the valve.
- The disc is mounted in a nylon bushing, which allows it to move slightly both horizontally and vertically to close completely tight also in case of minor impurities in the seat.
- Body and bonnet of ductile iron with epoxy coating to DIN 30677-2
- Possible to mount lever and weight for installations with an increased risk of water hammer at standard velocities. The weight is adjustable on the lever to achieve an optimum closing speed and a careful closing against the seat. Can be installed in different positions.
- Possible to mount lever and spring to prevent water hammer at high velocities

Accessories:

Lever and weight, lever and spring, valve guard kit, combi-flanges, flange adaptors.

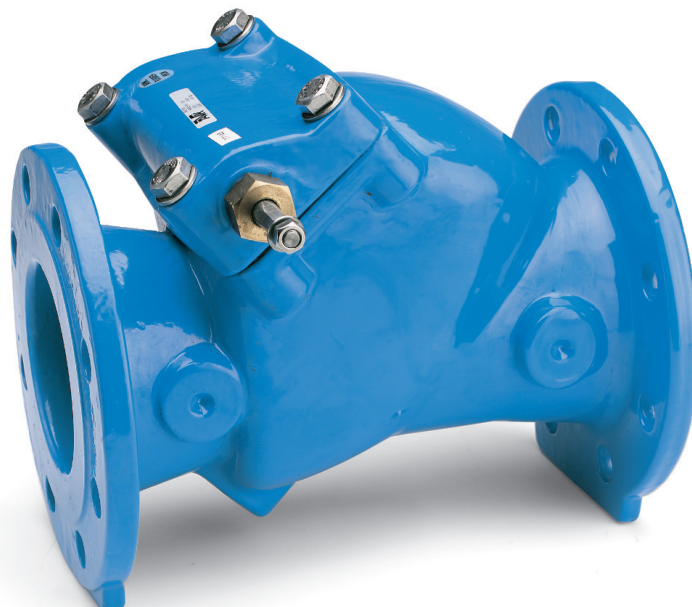

Expect... **AVR**

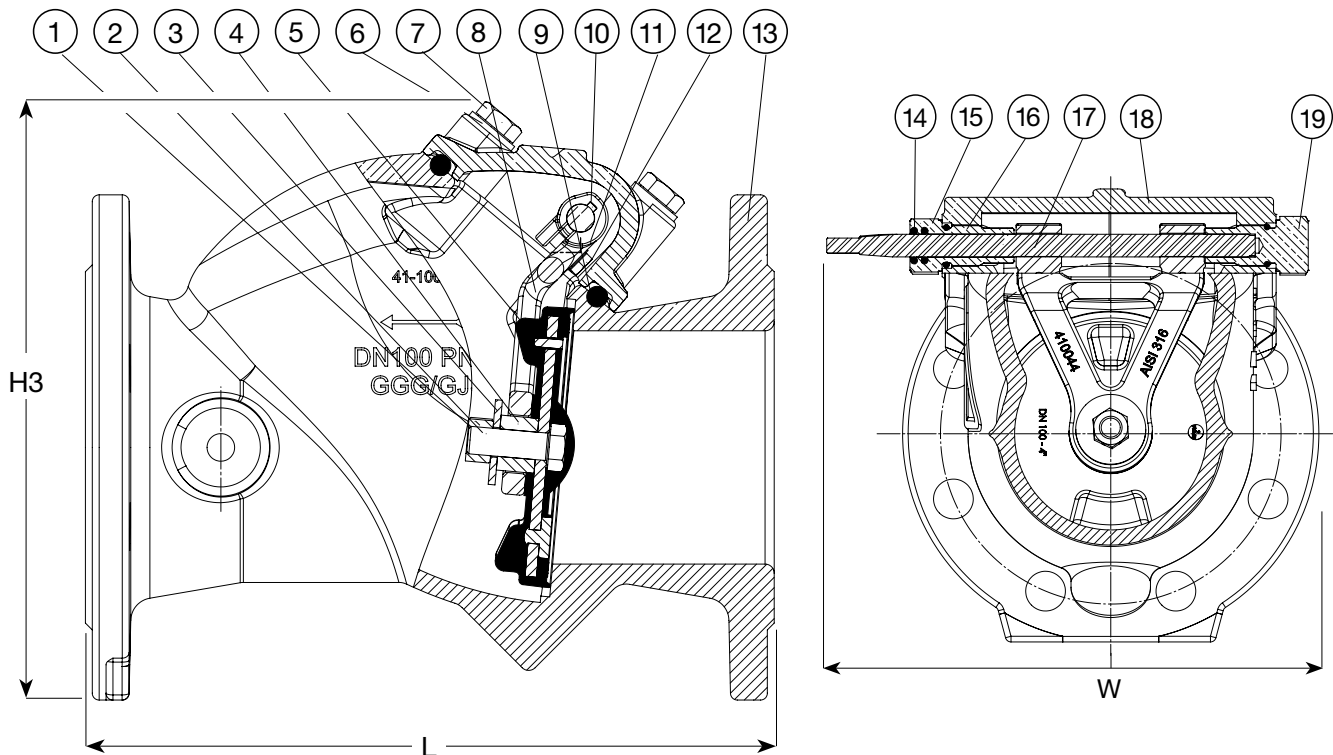

Component List:

1. Nut	Stainless steel A4	2. Bolt	Stainless steel A4
3. Washer	Stainless steel A4	4. Spacer	Nylon
5. Disc	EPDM with steel insert	6. Washer	Stainless steel A2
7. Bolt	Stainless steel A2	8. Hinge	AISI 316/GGG-50 in DN 250-300
9. Bonnet gasket	EPDM rubber	10. Key	Stainless steel A4
11. Washer	Stainless steel A4	12. Bolt	Stainless steel A4
13. Body	Ductile iron, EN-GJS-500-7 (GGG-50)	14. O-ring	NBR rubber
15. Open bushing	Dezincification resistant brass	16. O-ring	NBR rubber
17. Shaft	Stainless steel AISI 420	18. Bonnet	Ductile iron, EN-GJS-500-7 (GGG-50)
19. Closed bushing	Dezincification resistant brass		

Components may be substituted with equivalent or higher class materials without prior notification.

Reference Nos. and Dimensions:

AVK ref. nos	DN mm	Flange drilling	L mm	H3 mm	W mm	Theoretic. weight kg
41-050-60-018	50	PN16	200	193	221	13
41-065-60-018	65	PN16	240	233	231	16
41-080-60-018	80	PN16	260	240	261	20
41-100-60-018	100	PN16	300	260	323	26
41-125-60-018	125	PN16	350	322	323	36
41-150-60-018	150	PN16	400	338	340	51
41-200-60-008	200	PN10	500	400	395	83
41-200-60-018	200	PN16	500	400	395	83
41-250-60-008	250	PN10	600	473	635	183
41-250-60-018	250	PN16	600	473	635	183
41-300-60-008	300	PN10	700	541	664	231

The designs, materials and specifications shown are subject to change without notice. This is due to the continuous development of our product programme.

AVK ref. nos	DN mm	Flange drilling	L mm	H3 mm	W mm	Theoretic. weight kg
41-300-60-018	300	PN16	700	541	664	231