



## AVK HANDWHEEL, CTO

08/A

Fitting all standard gate valves

005



For manual operation of AVK gate valves and AVK service connection valves AVK recommends usage of our handwheels. AVK handwheels are of grey cast iron GJL-250 (GG-25) with epoxy coating to DIN 30677.



### Product Description:

Handwheel assembled with bolt and washer



### Features:

- Handwheel for service connection valves in black epoxy
- Handwheel for gate valves in blue epoxy



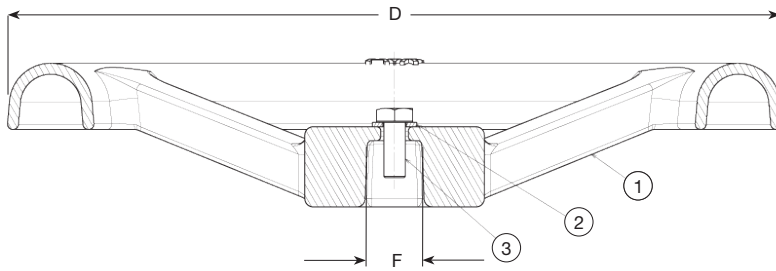

**Component List:**

1. Handwheel	Cast iron GJL-250	2. Washer	Stainless steel A2
3. Bolt	Stainless steel A2		

Components may be substituted with equivalent or higher class materials without prior notification.

**Reference Nos. and Dimensions:**

AVK ref. nos	DN/DN mm	D mm	F mm	Theoretical weight kg
08-050-06-0001	40 - 50	180	14	1.5
08-080-06-0001	65 - 80	225	17	2.0
08-100-06-0001	100 - 100	280	19	3.5
08-150-06-0001	125 - 150	320	19	4.5
08-200-06-0001	200 - 200	360	24	6.0
08-250-06-0001	250 - 300	500	27	11
08-400-06-0001	350 - 500	640	32	17
08-600-06-000 <sup>(1)</sup>	450 - 600	800	30	20
08-600-08-000 <sup>(2)</sup>	450 - 600	800	30	20

<sup>(1)</sup> CTO, for series 06 and 46, ø30  
<sup>(2)</sup> CTO, ø40